

EBAUCHES S. A.

NEUCHÂTEL

SWITZERLAND

Edited and published by Ebauches S. A.

(French, English, German, Italian, Spanish)

Copyright 1955 by Ebauches S. A.



FABRIQUE D'EBAUCHES
A. SCHILD S. A., GRENCHEN

11 1/2''' **1475**
ALERTIC
25,60 mm

Lever movement, direct sweep second, with

Alarm device

Caliber with two barrels

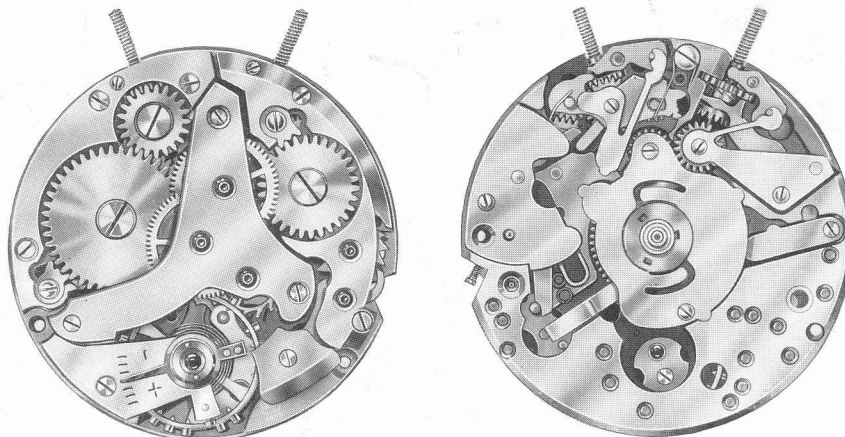

Enlarged movement

TECHNICAL AND PRACTICAL COMMUNICATION FOR THE GUIDANCE OF WATCH REPAIRERS

Description and numbering of spare parts according to the « Technological Dictionary of Watch Parts »,
2nd edition.

- 100 Plate
- 105 Barrel bridge
- 110 Train wheel bridge
- 121 Balance cock for flat hairspring
- 125 Pallet cock
- 126 Center wheel cock
- 182 Barrel and cover
- 195 Barrel arbor
- 206 Center wheel
- 210 Third wheel
- 227 Sweep second wheel
- 245 Cannon pinion
- 255 Hour wheel
- 260 Minute wheel
- 301 Regulator for flat hairspring
- 311 Upper cap jewel with end-piece, for balance
- 330 Lower cap jewel with end-piece, for balance
- 343 Bearing plate, non-jewelled for sweep second wheel
- 401 Winding stem
- 407 Clutch wheel
- 410 Winding pinion
- 415 Ratchet wheel
- 420 Crown wheel
- 422 Crown wheel ring
- 425 Click
- 430 Click spring
- 435 Yoke
- 440 Yoke spring
- 443 Setting lever
- 445 Setting lever spring
- 450 Setting wheel

- 705 Escape wheel and pinion with straight pivots
- 710 Jewelled pallet fork and staff
- 714 Pallet staff
- 721 Balance with flat hairspring, regulated
- 723 Balance staff, pivoted
- 730 Roller
- 770 Mainspring
- 7151 Unlocking wheel holder
- 7153 Alarm barrel bridge
- 7182 Alarm barrel with cover
- 7196 Alarm barrel arbor
- 7288 Unlocking wheel
- 7290 Alarm wheel
- 7296 Intermediate setting wheel for alarm
- 7307 Alarm setting and winding rocker
- 7310 Spring for alarm setting and winding rocker
- 7311 Spring for alarm setting connection wheel
- 7401 Alarm winding stem
- 7410 Alarm winding pinion
- 7417 Alarm ratchet wheel, lower
- 7418 Alarm ratchet wheel, upper
- 7421 Alarm crown wheel lower
- 7426 Alarm click
- 7436 Alarm click spring
- 7443 Alarm setting lever
- 7444 Alarm setting lever spring
- 7459 Disconnector

- 7488 Alarm bolt spring
- 7496 Alarm bolt
- 7498 Alarm hammer
- 7506 Alarm bolt lid
- 7771 Alarm mainspring
- 5102 Case screw
- 5105 Barrel bridge screw
- 5110 Trainwheel bridge screw
- 5121 Balance cock screw
- 5125 Pallet cock screw
- 5126 Center wheel cock screw
- 5311 Upper end-piece screw, for balance
- 5330 Lower end-piece screw, for balance
- 5343 Bearing plate screw, for sweep-second
- 5415 Ratchet wheel screw
- 5420 Crown wheel screw
- 5425 Click screw
- 5443 Setting lever screw
- 5445 Screw for setting lever spring
- 5738 Hairspring stud screw
- 5750 Dial screw
- 57151 Screw for unlocking wheel holder
- 57153 Screw for alarm barrel bridge
- 57311 Screw for spring for alarm setting connection wheel
- 57418 Screw for alarm ratchet wheel, upper
- 57426 Alarm click screw
- 57443 Alarm setting lever screw
- 57444 Screw for alarm setting lever spring
- 57459 Disconnector screw
- 57506 Screw for alarm bolt lid

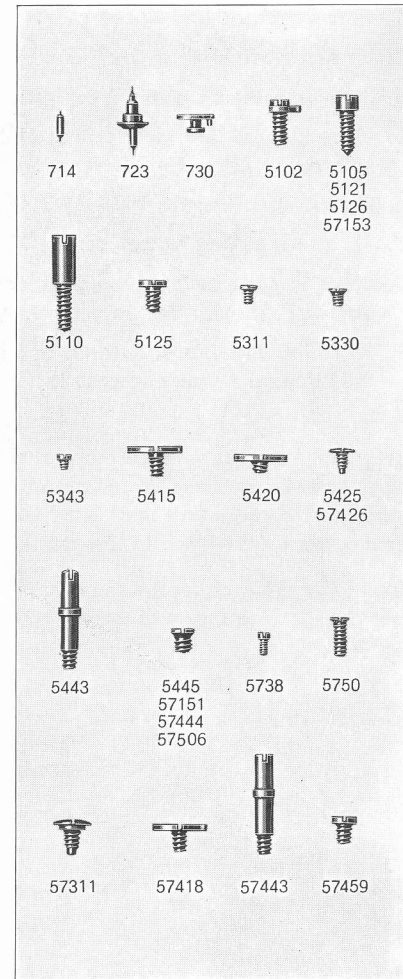
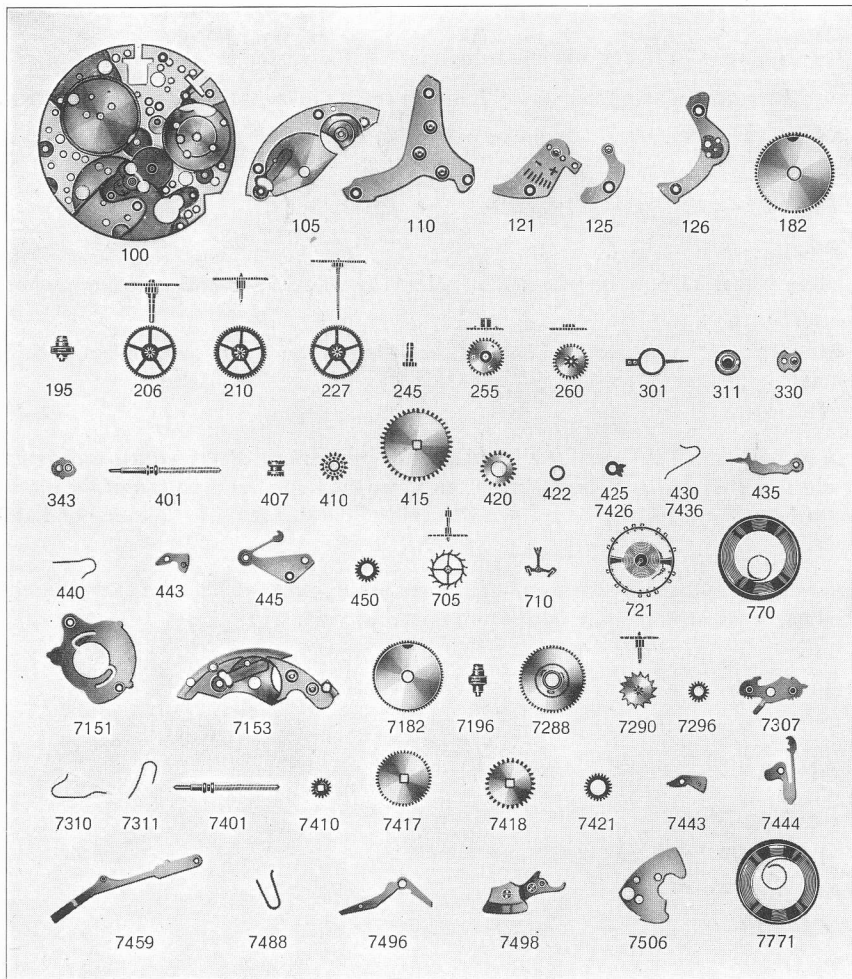

When ordering parts for a shock-protecting device, make certain to specify its exact type. For further details of the description and numbering of spare parts, see the « Technological Dictionary of Watch Parts », 2nd edition, published by Ebauches S. A.

Order repair parts through your jobber, giving the numbers and designations, thus insuring prompt and efficient deliveries.